



## FIVE-ACRE LEASEHOLD APPLICATION

This application applies only to those shareholders of Alaska Peninsula Corporation who are eligible to obtain a lease of one un-surveyed five-acre tract of surface land from Alaska Peninsula Corporation pursuant to its Plan of Merger.

*It is the responsibility of the applicant to ensure accuracy of land description, and to verify accessibility of land selection prior to submitting application.*

**Answer all questions as completely as possible. If you need more room, please attach extra sheets.**

1. **Name of Applicant:** \_\_\_\_\_

2. **Address:** \_\_\_\_\_

3. **Date of Birth:** \_\_\_\_\_

4. **Telephone Contact Information:** \_\_\_\_\_

5. **Applicant was originally a shareholder of: (check one)**

- A. Kokhanok Native Corporation
- B. Meshik Incorporated (Port Heiden)
- C. Newhalen Native Corporation
- D. Qinuyang, Limited (South Naknek)
- E. Ugashik Native Corporation

6. **State the location, coordinates and description of the land applied for (Use an extra sheet, if necessary):**

---

---

---

---

---

---

**7. Detailed location of land:**

Section \_\_\_\_\_ Lot \_\_\_\_\_ Township \_\_\_\_\_ S., Range \_\_\_\_\_ W. Seward Meridian

Containing approximately \_\_\_\_\_ acres.

**8. State the location and description of your proposed access to the land applied for:**

\_\_\_\_\_  
\_\_\_\_\_  
\_\_\_\_\_

**9. State whether your proposed access is by existing road, air, snowmobile/sled dog /ATV trail, pathway, river, stream, or otherwise: \_\_\_\_\_**

\_\_\_\_\_  
\_\_\_\_\_

**10. List names and addresses of each person who owns or claims the property over which your proposed access runs: \_\_\_\_\_**

\_\_\_\_\_  
\_\_\_\_\_

**11. Describe how you intend to use the land applied for: \_\_\_\_\_**

\_\_\_\_\_  
\_\_\_\_\_  
\_\_\_\_\_

**12. Does anyone other than you claim an interest in the land that you are applying for:**

Yes  No

If yes, by whom claimed and address: \_\_\_\_\_

\_\_\_\_\_  
\_\_\_\_\_  
\_\_\_\_\_

13. If there are any improvements on the land claimed, are those improvements claimed by anyone other than applicant? Yes  No

If yes, by whom claimed and address: \_\_\_\_\_  
\_\_\_\_\_  
\_\_\_\_\_  
\_\_\_\_\_

14. Please sketch the land claimed and access thereto on the map at page\_\_\_\_ of this application.

15. I hereby certify that I have not applied for or received a leasehold interest in any land pursuant to the plan of merger of Alaska Peninsula Corporation, and further that this application revokes any prior application by me.

16. The information contained in this application is accurate to the best of my knowledge.

Date: \_\_\_\_\_ Applicant Signature: \_\_\_\_\_

**ALASKA PENINSULA CORPORATION**  
**STAKING INSTRUCTIONS AND INFORMATION**  
**SHAREHOLDER FIVE-ACRE LEASE PROGRAM**

Eligible Alaska Peninsula Corporation (APC) shareholders are entitled to lease one (1) parcel not to exceed five (5) acres in size of designated APC lands pursuant to APC's Plan of Merger.

It is very important that the land be properly staked, described and located on a map. This packet includes instructions and information to assist and guide the shareholder in staking the parcel. This packet includes the following:

- A topographic map of APC land showing areas open for staking.
- A blank section map for sketching the parcel configuration and location staked.
- An illustrated sketch map showing all the information needed by APC to locate and identify each staked parcel.
- An example of metes and bounds.
- A set of examples showing proper and improper staking.

***Important staking information:***

1. Corners and side lines must be clearly marked by blazing and/or flagging trees, or cutting a straight line through the brush. This is so APC and others can determine where your boundaries are located. Boundaries shall be oriented North-South and East-West, except where boundaries lie adjacent to existing roads or water bodies.
2. The parcel must be reasonably compact and either square or rectangular in shape. No more than 330 feet of frontage may be claimed along a road or body of water. Parcels having 330 feet of frontage will be 660 feet deep to make a five-acre parcel. A square five-acre parcel not fronting on a road or water body will measure 467 feet on each side.
3. The five-acre lease application to be submitted to APC consists of seven pages--the application form and a sketch map. You must sketch your parcel on the map in accordance with these instructions and return it to APC with the application.
4. A sample written metes and bounds description is provided to assist in completing the application.

5. A good corner marker can be made from white plastic plumbing pipe. A 10-foot long piece of  $\frac{3}{4}$ " diameter pipe sells in Anchorage for less than \$4 per piece. It can be cut with a wood saw, it is light and durable, you can paint it and write on it with a felt-tip marker. The plastic pipe may be a good substitute if you cannot locate other suitable markers in your area. Another good corner marker is a 4" X 4" X 5' wooden post with the top two feet painted red or fluorescent orange. Each corner stake should have your name, address, the date of staking, and the corner number engraved or painted on it. An aluminum can with your name, address and date of staking engraved on it may be nailed to the corner post or squared tree.
6. In locating your parcel, you must make a common boundary with any parcel closer than 330 feet. If you do not wish to adjoin a neighboring parcel, you must move at least 330 feet away from the boundary of the nearest parcel. This is to avoid creating narrow slivers of land that are too narrow to stake and provide little or no utility for APC. This requirement does not apply for parcels separated by a public road rights-of-way or a river.
7. The land described in your application and accompanying map must be available for staking and not conflict with valid existing rights of other persons or entities.
8. Remember that you must stake only one parcel, and that the parcel must be part of the land that would have been conveyed to your village corporation if it had not merged with APC. Do not construct any improvements on the parcel you have staked until your application has been approved and you have entered into a written lease agreement with APC.

**Applicant Name:** \_\_\_\_\_ **Village:** \_\_\_\_\_

**Directions:**

Sketch your parcel and your access to it on this map.

This sketch does not have to be drawn to exact scale, but it should show the approximate location of the parcel within the section and how it relates to surrounding topographical features such as roads, lakes, and mountains.

Label the bearings and distances of all boundaries on your parcel and show other staked parcels, if known.

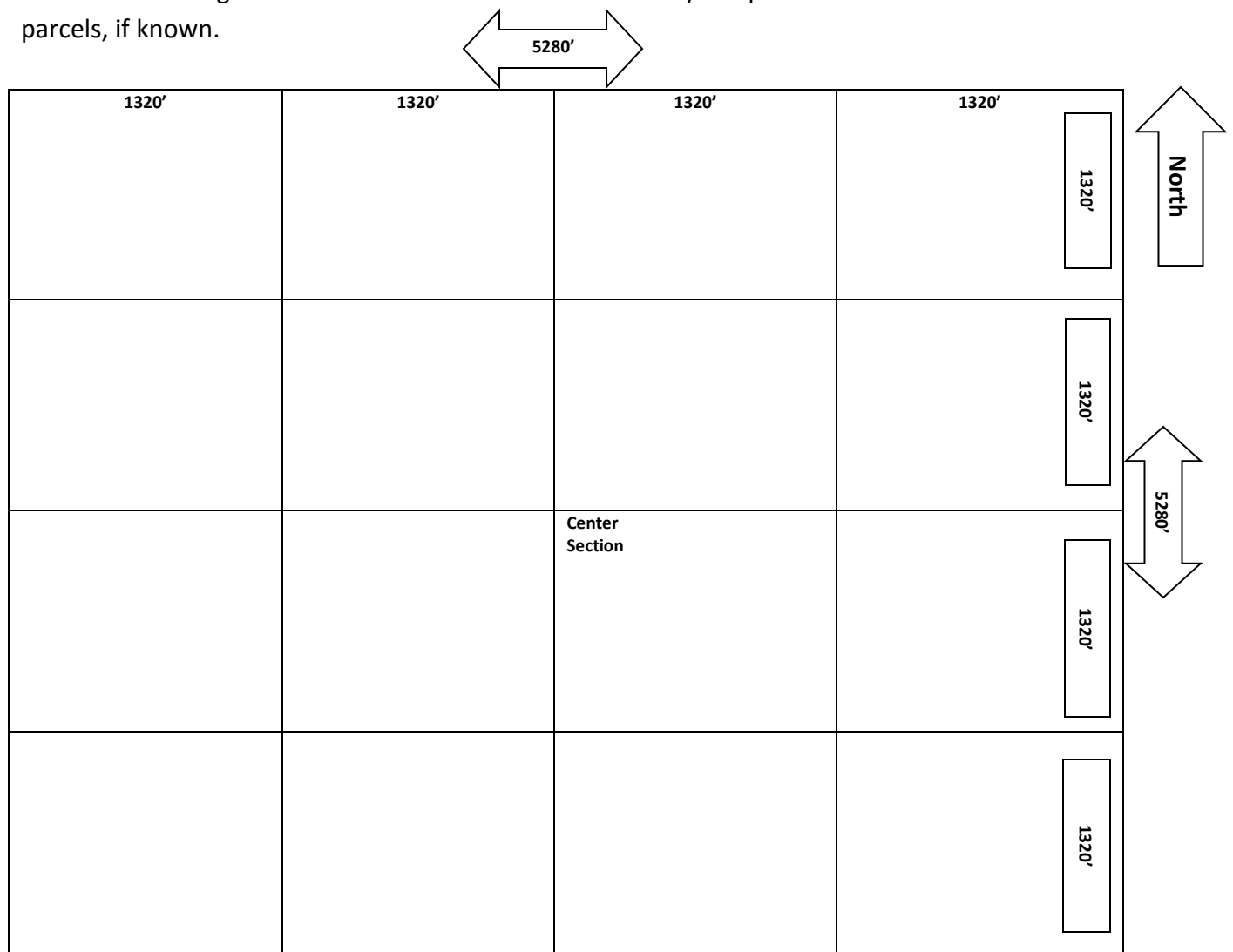

Scale: 1" = 1000'

Section \_\_\_\_\_ Lot \_\_\_\_\_ Township \_\_\_\_\_ South, Range \_\_\_\_\_ W. Seward Meridian